



Lydford Road, Maida Vale W9

£1,950 Per Month

Situated on a quiet residential road is this bright and airy one bedroom flat with private garden. The property comprises of a large reception room, fitted kitchen with doors leading out onto a private garden, a good size double bedroom and tiled bathroom. The property further benefits from its own private entrance and wood flooring throughout. Lydford Road is a sought after residential street only moments from the shops, bars and restaurants of both Maida Vale and Notting Hill, whilst the green open spaces of Paddington Recreation Ground are close by. Transport links include Maida Vale Underground Station (Bakerloo Line) and Westbourne Park (Hammersmith and City).

Available: 4th July 2026 | Offered: Part-furnished
EPC Rating: C | Council Tax: Westminster Band C

Lydford Road, Maida Vale W9

Reception
Large (Large)



Bathroom



Bedroom
Double (Double)



Garden



Kitchen
Fitted (Fitted)



Exterior



Lydford Road, Maida Vale W9

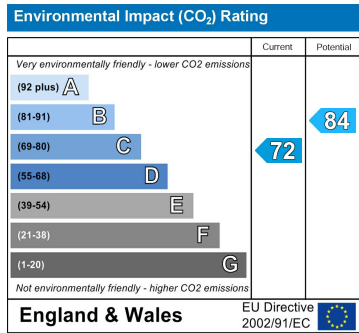
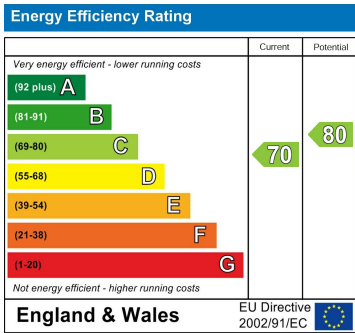
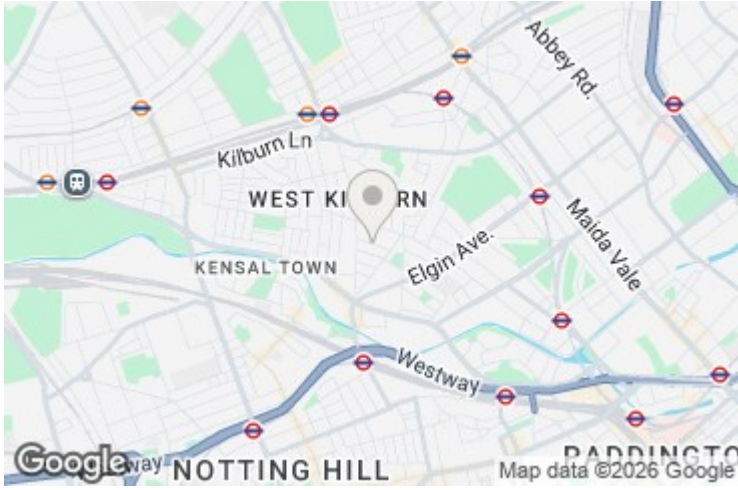

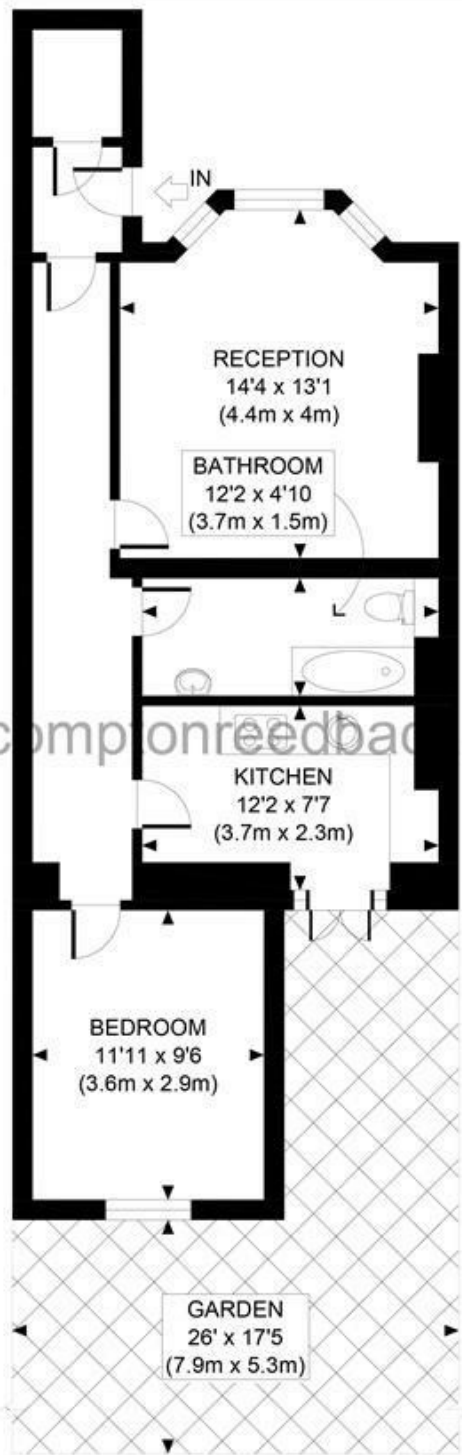

LOWER GROUND FLOOR
GROSS INTERNAL
FLOOR AREA 590 SQ FT

APPROX. GROSS INTERNAL FLOOR AREA 590 SQ FT / 55 SQM

Ref:

Copyright **photoplan**

Disclaimer: Floor plan measurements are approximate and are for illustrative purposes only. While we do not doubt the floor plan accuracy and completeness, you or your advisors should conduct a careful, independent investigation of the property in respect of monetary valuation

MAIDA VALE

75 Castellain Road
Maida Vale

London W9 1EU

T 020 7266 5000

F 020 7266 1119

E w9@comptonreeback.co.uk

Est. 1995

Registered Name: Compton Reeback Limited Registration Number: 6880098
Registered Office: 75 Castellain Road, Maida Vale, London W9 1EU

Directors: Brian Compton & Julian Reeback

IMPORTANT NOTICE: All of the information is intended only as a guide to a prospective purchaser and not constitute part of an offer or contract. Any measurements or distances referred to herein are approximate only. Any information contained herein (whether in the text, plans or photographs) is given in good faith but should not be relied upon as being a statement or representation of fact. Should you proceed with the purchase of the property, your solicitor must verify these details. We have not carried out a detailed survey nor tested the services, appliances and specific fittings. In accordance with current legislation we would advise you that the measurements on these particulars are imperial. The formula for conversion to metric is as follows: 1' (one foot) = 30.48cm (centimeters), 1m (one meter) = 3.29'(feet)

comptonreeback.co.uk