



Ashmore Road, Maida Vale W9

£2,475 Per Month

Compton Reeback are delighted to present this beautifully refurbished maisonette in Maida Vale.

Accessed via its own private entrance, the property immediately offers a sense of privacy and space, complemented by an abundance of natural light throughout. The accommodation comprises two double bedrooms with built-in wardrobes, a bright and spacious reception room, modern kitchen and tiled shower room.

Further benefits include wood flooring throughout, double-glazed windows and storage.

Ideally located, the property is within easy reach of the wide range of amenities along Salusbury Road and is just an 11-minute walk from Queen's Park Station (Bakerloo Line and London Overground) and 10 minutes walk from Westbourne Park Station (Hammersmith & City Line).

Available from 30th June 2026 | Part-furnished
EPC Rating: D | Council Tax: Westminster Band D

Ashmore Road, Maida Vale W9

Master Bedroom



Kitchen



Reception Room



Shower Room



Second Bedroom



Ext

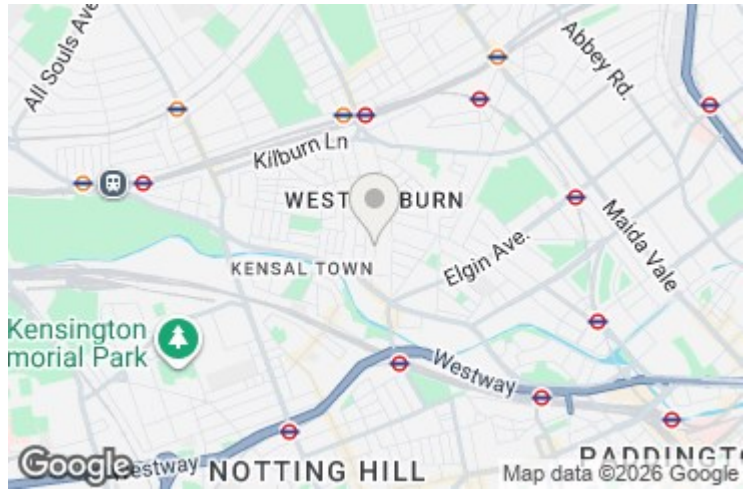

Ashmore Road, Maida Vale W9

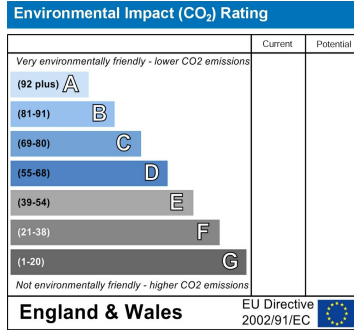
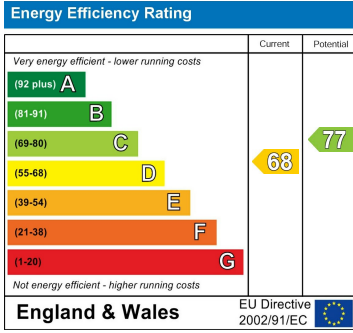

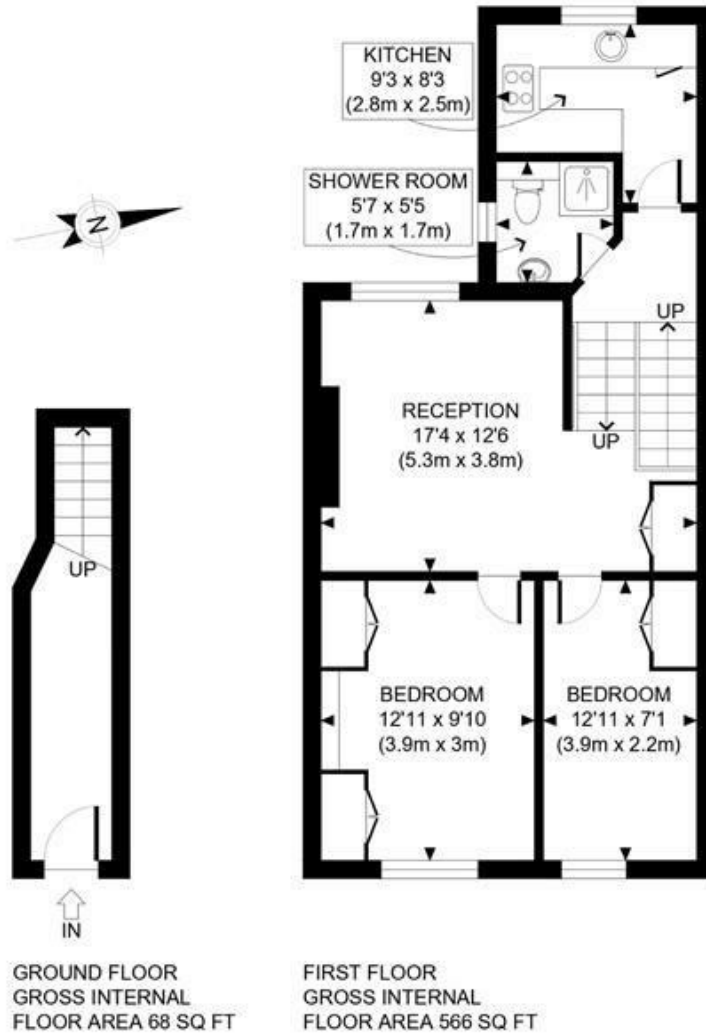

APPROX. GROSS INTERNAL FLOOR AREA: 634 SQ FT/ 59 SQM

This plan is for illustrative purposes only and should be used as such by any prospective client. Whilst every attempt has been made to ensure the accuracy of the Floor Plan contained here, measurements of the doors, windows, rooms and any other items are approximate and no responsibility is taken for any errors, omissions, or misstatement. The services, systems and appliances shown have not been tested and no guarantee as to the operability or efficiency can be given.

PROPERTY PHOTO PLANS COOK
ONE STOP SHOP FOR PROPERTY MARKETING

MAIDA VALE

75 Castellain Road
Maida Vale
London W9 1EU
T 020 7266 5000
F 020 7266 1119
E w9@comptonreeback.co.uk

Est. 1995

Registered Name: Compton Reeback Limited Registration Number: 6880098
Registered Office: 75 Castellain Road, Maida Vale, London W9 1EU

Directors: Brian Compton & Julian Reeback
IMPORTANT NOTICE: All of the information is intended only as a guide to a prospective purchaser and not constitute part of an offer or contract. Any measurements or distances referred to herein are approximate only. Any information contained herein (whether in the text, plans or photographs) is given in good faith but should not be relied upon as being a statement or representation of fact. Should you proceed with the purchase of the property, your solicitor must verify these details. We have not carried out a detailed survey nor tested the services, appliances and specific fittings. In accordance with current legislation we would advise you that the measurements on these particulars are imperial. The formula for conversion to metric is as follows: 1' (one foot) = 30.48cm (centimeters), 1m (one meter) = 3.29'(feet)

comptonreeback.co.uk