



Florence Court, London W9

£3,100 Per Month

Bright & charming property located in the sought-after area of Maida Vale. This delightful apartment Two double bedrooms situated on the seventh floor (lift) boasts wood flooring through out a fully fitted kitchen and a family bathroom & guest cloakroom. The property is located close to the shops & cafes of Little Venice and Warwick Avenue Tube (Bakerloo Line) is within easy reach.

Available from 29th October 2025. Offered Furnished
EPC Rating: E | Council Tax: Westminster Band F

Florence Court, London W9

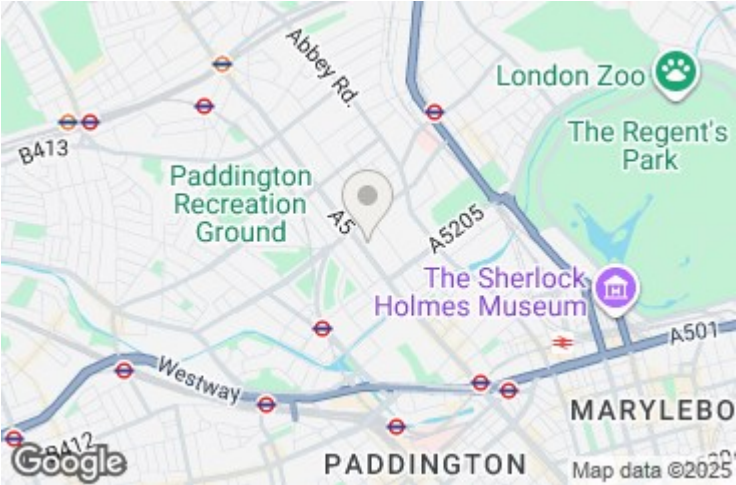

Energy Efficiency Rating		
	Current	Potential
Very energy efficient - lower running costs		
(92 plus) A		
(81-91) B		
(69-80) C		
(55-68) D		
(39-54) E		
(21-38) F		
(1-20) G		
Not energy efficient - higher running costs		
England & Wales	EU Directive 2002/91/EC	

Environmental Impact (CO ₂) Rating		
	Current	Potential
Very environmentally friendly - lower CO2 emissions		
(92 plus) A		
(81-91) B		
(69-80) C		
(55-68) D		
(39-54) E		
(21-38) F		
(1-20) G		
Not environmentally friendly - higher CO2 emissions		
England & Wales	EU Directive 2002/91/EC	

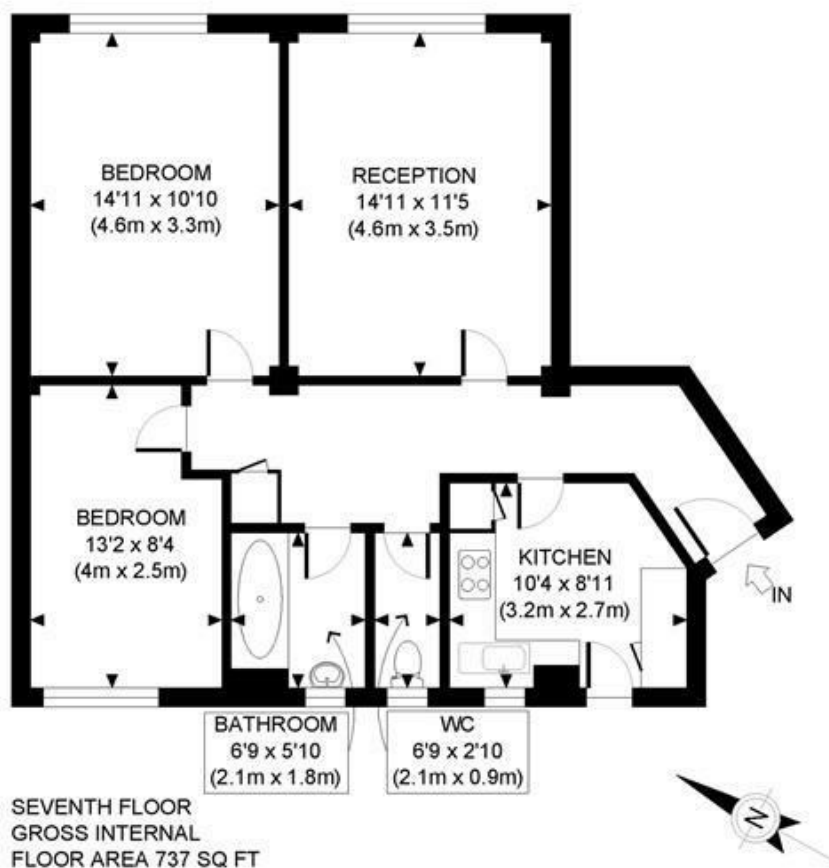

APPROX. GROSS INTERNAL FLOOR AREA: 737 SQ FT/ 68 SQM

PROPERTY PHOTO PLANS.CO.UK
ONE STOP SHOP FOR PROPERTY MARKETING

This plan is for illustrative purposes only and should be used as such by any prospective client. Whilst every attempt has been made to ensure the accuracy of the Floor Plan contained here, measurements of the doors, windows, rooms and any other items are approximate and no responsibility is taken for any errors, omissions, or misstatement. The services, systems and appliances shown have not been tested and no guarantee as to the operability or efficiency can be given.

MAIDA VALE

75 Castellain Road
Maida Vale
London W9 1EU

T 020 7266 5000

F 020 7266 1119

E w9@comptonreeback.co.uk

comptonreeback.co.uk

Est. 1995

Registered Name: Compton Reeback Limited Registration Number: 6880098
Registered Office: 75 Castellain Road, Maida Vale, London W9 1EU
Directors: Brian Compton & Julian Reeback

IMPORTANT NOTICE: All of the information is intended only as a guide to a prospective purchaser and not constitute part of an offer or contract. Any measurements or distances referred to herein are approximate only. Any information contained herein (whether in the text, plans or photographs) is given in good faith but should not be relied upon as being a statement or representation of fact. Should you proceed with the purchase of the property, your solicitor must verify these details. We have not carried out a detailed survey nor tested the services, appliances and specific fittings. In accordance with current legislation we would advise you that the measurements on these particulars are imperial. The formula for conversion to metric is as follows: 1' (one foot) = 30.4cm (centimeters), 1m (one meter) = 3.29' (feet)