



Wymering Road, London W9

£2,750 Per Month

Compton Reeback are delighted to present this exceptional top-floor, two-bedroom apartment located within the sought-after Wymering Mansions in the heart of Maida Vale.

This elegant residence features a spacious double reception room, a generous principal bedroom complete with floor-to-ceiling fitted wardrobes, a well-appointed bathroom, and a distinctive second bedroom showcasing a stylish New York-inspired mezzanine level. The separate eat-in kitchen enjoys views over the beautifully maintained communal gardens, providing a serene backdrop.

Positioned on the top floor of one of Maida Vale's premier mansion blocks, the apartment benefits from an abundance of natural light and offers scenic views from a private balcony.

Available from early September. Offered part-furnished.
EPC Rating: D | Council Tax: Westminster Band E

Wymering Road, London W9

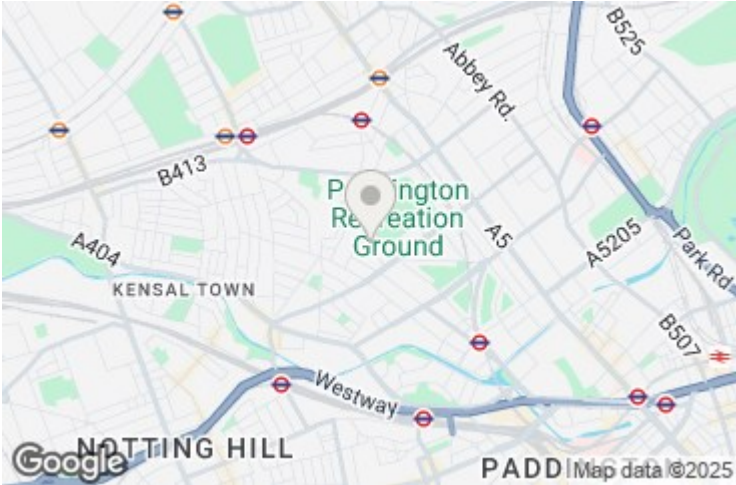

Energy Efficiency Rating		
	Current	Potential
Very energy efficient - lower running costs		
(92 plus) A		
(81-91) B		
(69-80) C		
(55-68) D		
(39-54) E		
(21-38) F		
(1-20) G		
Not energy efficient - higher running costs		
England & Wales	EU Directive 2002/91/EC	

Environmental Impact (CO ₂) Rating		
	Current	Potential
Very environmentally friendly - lower CO2 emissions		
(92 plus) A		
(81-91) B		
(69-80) C		
(55-68) D		
(39-54) E		
(21-38) F		
(1-20) G		
Not environmentally friendly - higher CO2 emissions		
England & Wales	EU Directive 2002/91/EC	

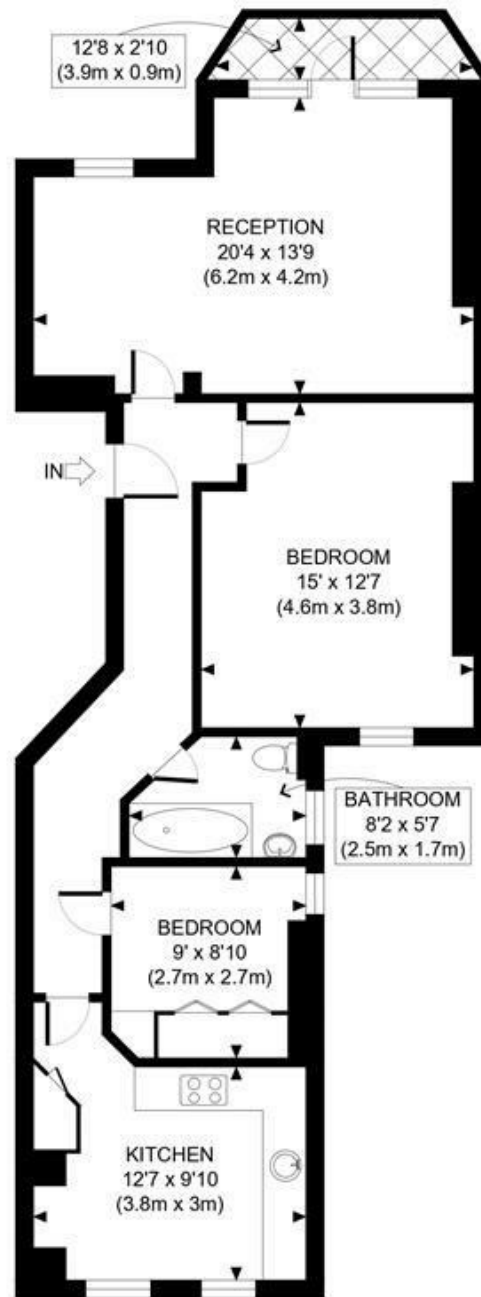

FOURTH FLOOR
GROSS INTERNAL
FLOOR AREA 820 SQ FT

APPROX. GROSS INTERNAL FLOOR AREA: 820 SQ FT/ 76 SQM

PROPERTY PHOTO PLANS.CO.UK
ONE STOP SHOP FOR PROPERTY MARKETING

This plan is for illustrative purposes only and should be used as such by any prospective client. Whilst every attempt has been made to ensure the accuracy of the Floor Plan contained here, measurements of the doors, windows, rooms and any other items are approximate and no responsibility is taken for any errors, omissions, or misstatement. The services, systems and appliances shown have not been tested and no guarantee as to the operability or efficiency can be given.

MAIDA VALE

75 Castellain Road
Maida Vale

London W9 1EU

T 020 7266 5000

F 020 7266 1119

E w9@comptonreeback.co.uk

comptonreeback.co.uk

Est. 1995

Registered Name: Compton Reeback Limited Registration Number: 6880098
Registered Office: 75 Castellain Road, Maida Vale, London W9 1EU

Directors: Brian Compton & Julian Reeback
IMPORTANT NOTICE: All of the information is intended only as a guide to a prospective purchaser and not constitute part of an offer or contract. Any measurements or distances referred to herein are approximate only. Any information contained herein (whether in the text, plans or photographs) is given in good faith but should not be relied upon as being a statement or representation of fact. Should you proceed with the purchase of the property, your solicitor must verify these details. We have not carried out a detailed survey nor tested the services, appliances and specific fittings. In accordance with current legislation we would advise you that the measurements on these particulars are imperial. The formula for conversion to metric is as follows: 1' (one foot) = 30.48cm (centimeters), 1m (one meter) = 3.29' (feet)