



Shirland Road, London W9

£2,500 Per Month

AVAILABLE FROM 1ST JUNE 2025 – ALL BILLS INCLUDED

Modern, stylish flats available with private en-suite showers and built-in kitchenettes, fully furnished and ready to move in. Each unit comes complete with kitchenware, fresh bed linen, towels, and monthly cleaning included.

Enjoy a convenient, comfortable lifestyle with everything you need right on your doorstep.

Key Features:

Luxury Double Bed

Private En-Suite Shower Room

Built-In Kitchenette with Oven/Microwave

Shirland Road, London W9

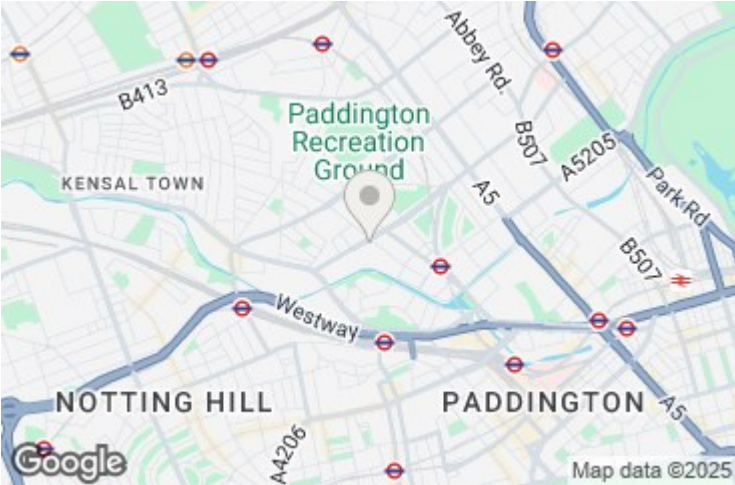

Energy Efficiency Rating		
	Current	Potential
Very energy efficient - lower running costs		
(92 plus) A		
(81-91) B		
(69-80) C		
(55-68) D		
(39-54) E		
(21-38) F		
(1-20) G		
Not energy efficient - higher running costs		
	68	
England & Wales	EU Directive 2002/91/EC	

Environmental Impact (CO ₂) Rating		
	Current	Potential
Very environmentally friendly - lower CO ₂ emissions		
(92 plus) A		
(81-91) B		
(69-80) C		
(55-68) D		
(39-54) E		
(21-38) F		
(1-20) G		
Not environmentally friendly - higher CO ₂ emissions		
England & Wales	EU Directive 2002/91/EC	

Shirland Road, London, W9

Approximate Gross Internal Floor Area = 17.8 q m / 192 sq ft

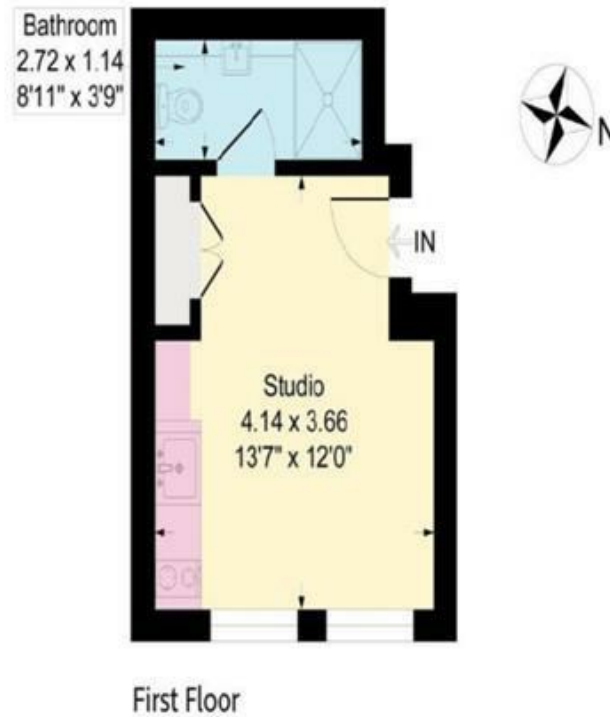

Illustration for identification purposes only, measurements are approximate, not to scale.

Est. 1995

Registered Name: Compton Reeback Limited Registration Number: 6880098
Registered Office: 75 Castellain Road, Maida Vale, London W9 1EU

Directors: Brian Compton & Julian Reeback

IMPORTANT NOTICE: All of the information is intended only as a guide to a prospective purchaser and not constitute part of an offer or contract. Any measurements or distances referred to herein are approximate only. Any information contained herein (whether in the text, plans or photographs) is given in good faith but should not be relied upon as being a statement or representation of fact. Should you proceed with the purchase of the property, your solicitor must verify these details. We have not carried out a detailed survey nor tested the services, appliances and specific fittings. In accordance with current legislation we would advise you that the measurements on these particulars are imperial. The formula for conversion to metric is as follows: 1' (one foot) = 30.4cm (centimeters), 1m (one meter) = 3.29'(feet)

MAIDA VALE

75 Castellain Road

Maida Vale

London W9 1EU

T 020 7266 5000

F 020 7266 1119

E w9@comptonreeback.co.uk

comptonreeback.co.uk