



**Elgin Avenue, Maida Vale W9**

**£465 Per Week**

This fantastic, well located bright and airy large one bedroom apartment is set on the raised ground floor of this period conversion. The flat comprises of a large reception room, an excellent size eat in fully fitted kitchen, superb master bedroom and a tiled bathroom. The flat benefits from high ceilings and wood stripped floors throughout as well as many original features. Elgin Avenue is only a short walk from Paddington Recreational Ground and a wide selection of shops, cafes and restaurants in Maida Vale and Little Venice. The flat provides easy access to the West-End with both Maida Vale and Warwick Avenue stations (Bakerloo line) a short walk away. Available towards the end of January and offered on a furnished basis. SOLE AGENTS. EPC Rating D. Council Tax Band F.

# Elgin Avenue, Maida Vale W9

## Reception

Bright (Bright)

## Bedroom

Double (Double)

## Kitchen

Eat - In (Eat - In)

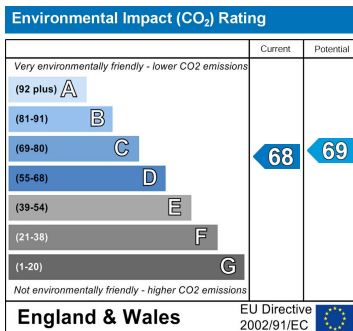
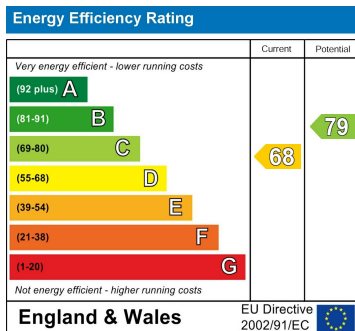
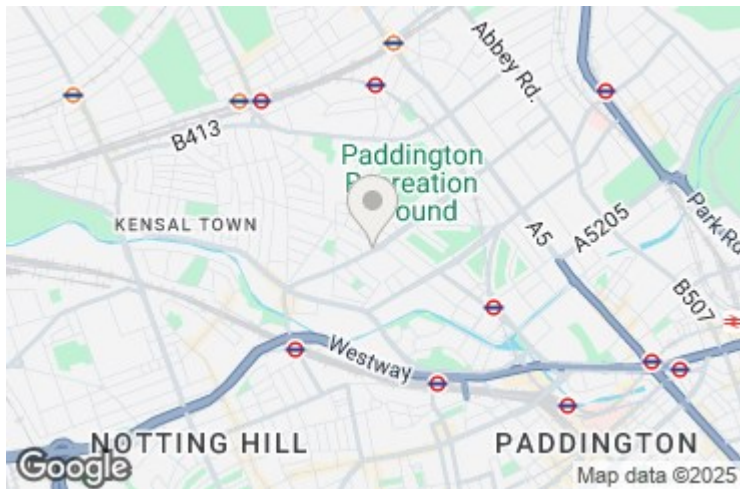

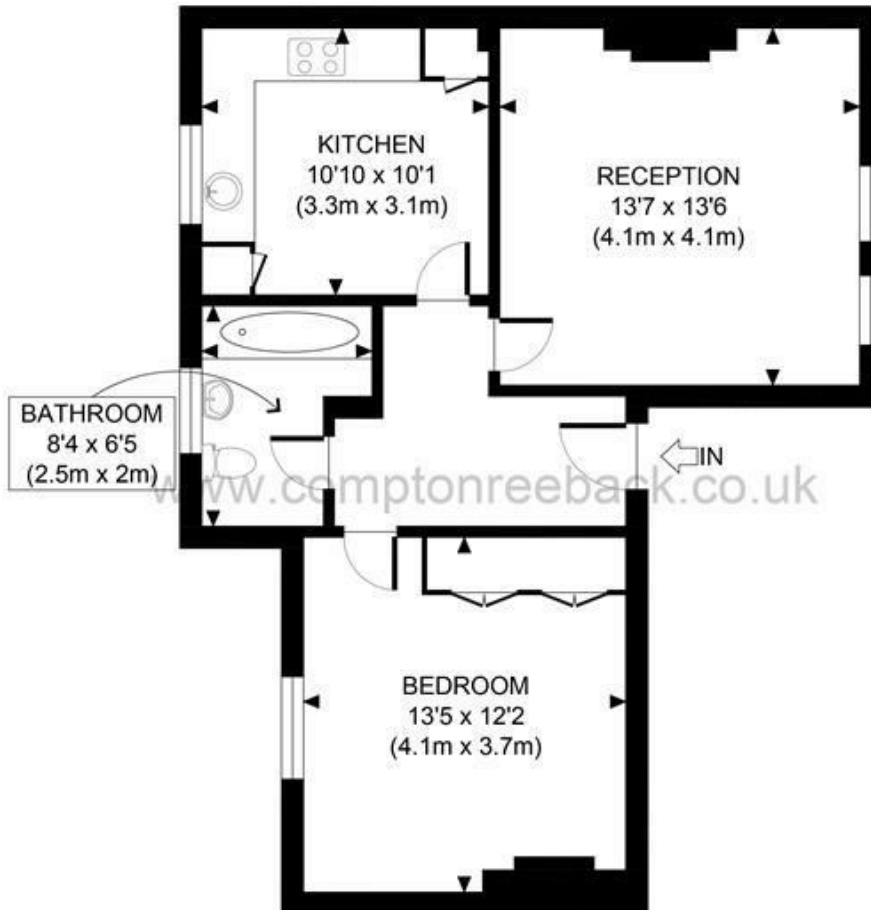

RAISED GROUND FLOOR  
GROSS INTERNAL  
FLOOR AREA 588 SQ FT

APPROX. GROSS INTERNAL FLOOR AREA 588 SQ FT / 55 SQM

Ref:

Copyright **photoplan** 

Disclaimer: Floor plan measurements are approximate and are for illustrative purposes only. While we do not doubt the floor plan accuracy and completeness, you or your advisors should conduct a careful, independent investigation of the property in respect of monetary valuation

MAIDA VALE

75 Castellain Road  
Maida Vale

London W9 1EU

T 020 7266 5000

F 020 7266 1119

E [w9@comptonreeback.co.uk](mailto:w9@comptonreeback.co.uk)

Est. 1995

Registered Name: Compton Reeback Limited Registration Number: 6880098  
Registered Office: 75 Castellain Road, Maida Vale, London W9 1EU

Directors: Brian Compton & Julian Reeback

IMPORTANT NOTICE: All of the information is intended only as a guide to a prospective purchaser and not constitute part of an offer or contract. Any measurements or distances referred to herein are approximate only. Any information contained herein (whether in the text, plans or photographs) is given in good faith but should not be relied upon as being a statement or representation of fact. Should you proceed with the purchase of the property, your solicitor must verify these details. We have not carried out a detailed survey nor tested the services, appliances and specific fittings. In accordance with current legislation we would advise you that the measurements on these particulars are imperial. The formula for conversion to metric is as follows: 1' (one foot) = 30.48cm (centimeters), 1m (one meter) = 3.29' (feet)

[comptonreeback.co.uk](http://comptonreeback.co.uk)